

# Susquehanna Sidetracks

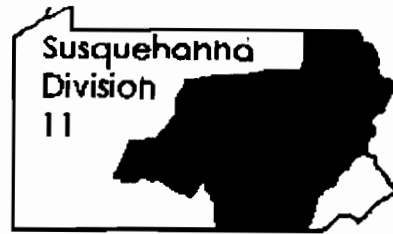

Serving the Susquehanna Valley, MER, NMRA, Inc.

NMRA/MER

Susquehanna Division 11 July - Sept 1997

Vol. 5 No. 3

## Bellefonte, Lockhaven Meet

The Susquehanna Division 11 will hold its summer mini-convention in the Bellefonte and Lockhaven, PA area on August 9, 1997. The morning session will be held at the Nittany Valley Model Railroad Club at 100 North Allegheny Street in Bellefonte, PA. The club is located below Confer's Jewelers. The layout will be in full operation, so bring your cameras along.

The afternoon session will be at the Clinton Central Model Railroad Club at 15 Logan Avenue, Castanea, PA. This is 3/4 mile south of Lockhaven, PA in the New York Central railroad station. The meeting and clinics will be held from 11:30 am to 3:30 pm.

The maps for these two locations are repeated in this issue of the Susquehanna Sidetracks. This should prove to be a very full day of model railroading. *DGY*

## Prototype and Modeler's Notes

*By Wm. Terry Nesbit*

**The TTX Company** has placed an order with the Thrall Car Manufacturing Company for 200 articulated bi-level rack cars for use in transporting finished automobiles and light trucks.

**The Union Pacific** has begun construction of a 600 acre \$70-million intermodal terminal in Memphis, TN.

**CSX Transportation** has introduced the Appalachian Service Lane that focuses on improving service to the coal regions of Kentucky, Tennessee, and western Virginia.

**Norfolk Southern and CSX** are bringing bar-cod capabilities to the coal industry. They are tying the automatic car readers to the mine location and weigh stations permitting inventory information to be transmitted to the home office and the railroads and a customer invoice is generated. This eliminates a very antiquated paper based system.

## Coming Events

**July 27 to August 2, 1997:** NMRA National Convention, Madison, WI.

**August 9, 1997:** Susquehanna Division 11 Summer Mini-Meet, Nittany Valley Model Railroad Club, Bellefonte, PA and the Clinton Central Model Railroad Club, Castanea, PA.

**September 14, 1997:** York-Hanover Train meet, Porters Fire Hall, Porters, PA, 9 am to 2pm. Info: 717-632-3157

**September 20-21, 1997:** Planes, Trains, & Automobiles Transportation Show, The Mid Atlantic Air Museum, Reading Regional Airport, 11 Museum Drive, Reading, PA 19605. 9am to 5pm Sat. and Sun.

**October 4, 1997:** Harrisburg - Marysville, PA Train Meet, Pennsylvania Rails Annual Oktoberfest, Marysville Lions Club Park Building, Marysville, PA, 9 am to 3 pm, adults \$4, under 12 free. Dealers: \$20 per table. Info: Michael Yingling, 717-540-1688

**November 7-9, 1997:** Mid-Eastern Region Fall 1997 Convention, "Brandywine Junction 97", hosted by the Philadelphia Division, Chadds Ford Ramada Inn, Routes 202 and 1, 1110 Baltimore Pike, Glen Mills, PA. Info: Registrar, John Nawn, P.O. Box 741, Paoli, PA 19301 Ph: 610-461-8644

**November 22, 1997:** First Annual Susquehanna Division 11 Modular Meet, Zembo Temple, Harrisburg, PA.

**November 26, 1997:** Conewago Valley Model Railroad Club Annual Auction, New Oxford Fire Hall, New Oxford, PA 7 pm until ?

**December 7, 1997:** York-Hanover Train Meet, Porters Fire Hall, Porters, PA, 9 am to 2 pm. Info: 717-632-3157

**December 13, 1997:** York, PA Train Meet, Pennsylvania Rails Annual York Meet, York Fairgrounds, York, PA, 9 am to 3 pm, adults \$4, under 12 free, dealers: \$20 per table. Info: Michael Yingling, 717-540-1688

**December 27, 1997:** Susquehanna Division 11 Modular Show, Hershey Medical Center's Children's Hospital Ward. (*Open only to children at the hospital and members with modules to setup*).

## Division 11 Staff

**Superintendent:** Terry Nesbit, 5760 Union Deposit Road, Harrisburg, PA 17111-4708. Ph. 717-657-9476

**Asst. Superintendent:** Brian C. Brandt, 337 Bracken Drive, Lancaster, PA 17601. Ph. 717-560-9542 or 717-581-0647 email: BrianB4717@aol.com or trains@redrose.net

**Chief Clerk:** Paul F. Tice, 1709 West Market Street, York, PA 17404. Ph. 717-843-9572

**Newsletter Editor:** Don Yingling, 2420 Heather Road, York, PA 17404-4383. Ph. 717-764-2676 email: Trolleynut@aol.com

**Achievement Program Chairman:** Terry Nesbit, 5760 Union Deposit Road, Harrisburg, PA 17111-4708. Ph. 717-657-9476

**Scouting Merit Badge for York & Adams Counties:** Alan Frame, 2430 Opal Road, York, PA 17404. Ph. 717-767-4998

**Scouting Merit Badge for Cumberland, Perry, & Dauphin Counties:** David C. Buchanan, 118 Forest Drive, Camp Hill, PA 17011-8304. Ph. 717-737-7029

**Scouting Merit Badge for Lancaster, Lebanon, & Berks Counties:** Jeremy Griffith, 352 Broad Street, Terre Hill, PA 17581. Ph. 717-445-5183

**Division All-Scale Module Coordinator:** Mel Agne, 48 Oakwood Drive, Delta, PA 17314. Ph. 717-862-3937

**Division Membership Chairman:** Jim Atkinson, 120 Colebrook Road, Elizabethtown, PA 17022. Ph. 717-367-5626

*Susquehanna Sidetracks* is the Official Publication of the Susquehanna Division 11 of the Mid-Eastern Region of the National Model Railroad Association, Inc. Dues are \$2.00 per year payable to "Susquehanna Division 11". Remit dues to the Chief Clerk. Dues include subscription to the Division newsletter. Deadlines for submissions to the Newsletter are the first day of each quarter: January 1 for Jan-Mar; April 1 for Apr-Jun; July 1 for Jul-Sep; and October 1 for Oct-Dec.

## Why?

A few things to ponder until next issue.

Why don't sheep shrink when it rains?

How does the guy who drives a snow plow get to work?

If the 7-11 is open 24 hours a day, 7 days a week, why are there locks on the doors?

## Super's Corner

*By Terry Nesbit*

At our spring meeting, held at the Lower Anthracite Model Railroad Club in Shamokin, I had planned on having a vote on the revised division by-laws. However, this did not occur, as the Mid-Eastern Region is in the process of revising their own by-laws. The MER by-laws will not be voted upon by the members until November of this year. The final version of these by-laws will have a significant impact on our division by-laws. Therefore, our division by-laws will need to be brought in line with the Mid-Eastern Region by-laws and I would expect to have the division's version reviewed and ready to be voted upon in the Spring of 1998.

While I was out reviewing a site for a future meet, I stopped at one of my favorite hobby shops, Rules in Manheim. While I was there, I discovered a long time friend of mine had passed away in December of 1995. The first time I was in Rules was when I was in college in the mid-sixties and his hobby shop was on North Queen Street in Lancaster. I can remember having many wonderful discussions about the hobby of model railroading and his support of a local model railroad club. Over the years the shop moved to Lititz and then to its current home in Manheim. Lurue Rule was a postman by trade for over 33 years and I will miss our discussions of the memories of Pennsylvania and Reading Railroad mainline steam. His sons are continuing the tradition. Keep up the good work for the hobby as a whole needs more people like the Rules, who take an interest in our next generation of model railroaders.

Our division, the region and the S gauge hobbyists have lost an extraordinary modeler, John Henry Long passed away in his sleep on the 3rd of May. Also, our sympathy goes to Mike Caum, who's father passed away after a long illness.

On another note ... the NMRA is in the final stages of a patent application, which, I am told, will "... revolutionize the hobby of Model Railroading ... ." I am not at liberty to release any additional details but, when permission is granted, I will let my members know.

This issue of the *Susquehanna Sidetracks* was produced for the cost of mailing only. Jim Atkinson has volunteered the use of his photocopier and I, as the Superintendent, purchased a case of paper and donated it to the division. This has effectively reduced our annual publication costs by \$400 to \$600. I am currently looking into a Non-Profit mailing permit and adding an advertising page for hobby shops and railroad related activities to offset the division's negative cash flow. These actions will effectively keep the dues at \$2.00 per year.

For the good of the order, watch out for those trains and have a rail fun day ...

## Editor's Notes

We recently lost a very dear friend, a fellow model railroader, who gave much of his time and himself to help the MER and Division 11. I will always remember going to a meet or convention and seeing his big, broad, warm smile with his outstretched hand and welcoming you there. He always made everyone feel comfortable. John Long loved this hobby and everyone loved him. Always willing to help. John Long was also the authority figure. When he spoke, you listened. John, you will be missed and not soon forgotten. I would like to say a big Thank You to his wife Virginia for sharing him with us. John, may you rest in peace. God bless you and thank you from all of us.

## Membership Thermometer

**Current Membership 7/3/97: 104**

### New Members:

Larry R. Hubley, Spring Grove, PA

### Renewals:

Robert R. Reitzel, Harrisburg, PA

Thomas R. Long, Spring Grove, PA

Richard Raubenstine, Jr., York, PA

Alan Mende, Hummelstown, PA

Bob Sheriff, Enola, PA

R. Dave Cray, York, PA

If your address label has a highlighted membership number then you have not renewed your division dues and this is your last newsletter.

## Achievement Program

*by Wm. Terry Nesbit*

The following NMRA members who reside in our division have received recognition for their 50 or 25 years of continuous membership.

### 50 Years, since 1947:

R. Gregory Sutcliffe, Jr. of Barto

### 25 Years, since 1971:

Howard M. Etter, Newville

Archer L. Morgan, Jr., Lancaster

Selwyn Parks, Jr., Mount Union

Douglas E. Peters, Allentown

Donald D. Storms, York

Ralph E. Wilcox, Altoona

### 25 Years, since 1972:

Frederic H. Abendschein, Columbia

K. C. Hollister, Gettysburg

Bryce E. Hoverter, Jr., Akron

Sam Koury, Shenandoah

John W. Mathias, Hanover

Eugene L. Weaver, Mt. Holly Springs

## Steam Train Operating Seminar

Would you like to feel the power and pride of operating a full size steam locomotive? This is the dream of every steam enthusiast! If you would, your opportunity has arrived. The Williams Grove Steam Line presents the chance for a 30 minute train operating seminars, with a certified instructor at the cost of \$45 and the 30 minutes will be spent in the cab of our own steam locomotive. If you think this is for you, contact Bill Medlin at 717-473-5659. Seminars are limited, August 25 through 29, 1997, at Williams Grove, PA. So, Contact Bill as soon as possible to reserve your spot on our schedule.

This seminar is sponsored by the Williams Grove Historical Steam Engine Association, Inc.

By the way, if you are not familiar with the engine the association has, it's PRR #643, a class B-4a 0-6-0 built in PRR's Altoona shops in 1901. The K-4s # 1361 in pieces at Steamtown and #7002 and #1224 now on permanent display at the Railroad Museum of Pennsylvania. The #643 is, as far as I know, the only operable Pennsy engine. *Alan Mende*

# SUSQUEHANNA DIVISION 11 1997 EVENT CALENDAR

**MAY 10: DIVISION 11 SPRING MINI-MEET AT SHAMOKIN**, Lower Anthracite Model Railroad Club, Shamokin Community Center, Independence Street, 2nd Floor above the Library. Largest model railroad club in Pennsylvania, 3475 sq. ft., 100% sceniced. To be featured in a future issue of Model Railroader magazine. **DIRECTOR ELECTIONS, CLINICS, AND MODULAR CLINIC "E"**. Structure building and prototype weathering. 9 am to 3 pm.

**MAY 23-25: MER SPRING '97 CONVENTION IN ASHEVILLE, NC.**

**JUNE 28: MODULAR CLINIC "F"**. Scenery and ballast application.

**Wm. Nesbit's home**, 5760 Union Deposit Road, Harrisburg, Ph. 717-657-9476. 10:00am to 2:00pm.

**JULY 19: MODULAR CLINIC "A" OR "B"**.

**Jack Kennedy's home**, 113 East Maplewood, Mechanicsburg, Ph. 717-766-9522. 10:00am to 2:00pm.

**JULY 27 - AUG 2: NMRA NATIONAL CONVENTION IN MADISON, WI.**

**AUGUST 9: DIVISION 11 SUMMER MINI-MEET AT BELLEFONTE AND AT LOCKHAVEN MODEL RAILROAD CLUBS. MODULAR CLINIC "C" AND "D"**. In the morning, from 9:00 am to 11:00 am, see the **Nittany Valley Model Railroad Club** in full operation and then from 11:30 am to 3:30 pm, the meeting and clinics will be at the **Clinton Central Model Railroad Club**, inside a former New Central Railroad Station, located at 15 Logan Avenue, Castanea, PA. Modular Clinic, repeat of "C", basic scenery support, castings and painting and "D", making ground foam scenery materials, water and trees. **Bellefonte and Lockhaven, PA**

**SEPTEMBER 20 & 21: Planes, Trains, and Automobiles Transportation Show** at the Mid Atlantic Air Museum, Reading Regional Airport, 11 Museum Drive, Reading, PA. Show times are 9am to 5pm both days. We will have a table at this show.

**SEPTEMBER 27: MODULAR CLINIC "E" OR "F"**.

**H. Eugene Boll**, 3925 Ridgewood Rd., York, Ph. 717-755-5642. 10:00am to 2:30pm. Joint meeting with **Susquehanna Valley Garden Railway Society** members.

**OCTOBER 25: MODULAR CLINIC TO CHECK QUALITY STANDARDS OF ALL OPERATING EQUIPMENT AND INDIVIDUAL MODULES NOT CERTIFIED** for the Division Module Show.

**Paul Tice's home**, Box 258-A-3 Moul Road, Thomasville, Ph. 717-225-1688. 10:00am to 4:00pm.

**NOVEMBER 7-9: MER FALL CONVENTION IN PAOLI, PA.**

**NOVEMBER 22: FIRST ANNUAL SUSQUEHANNA DIVISION 11 MODULAR MEET IN HARRISBURG AT THE ZEMBO TEMPLE**. Open to the public for an entrance fee and no charge to Division 11 members. See various local modular layouts in operation. **9:30 am to 4 pm. (set-up time 6am to 9:30 am... take down time 4 pm to 6 pm)**

**NOVEMBER 26: CONEWAGO VALLEY MODEL RAILROAD CLUB AUCTION AT NEW OXFORD**. The Division has a table and 2 or 3 volunteers are needed from 6:30pm to 11pm.

**DECEMBER 6: MODULAR CONSTRUCTION DAY**. Cut all parts

**Robert Troutman's home**, Reading, Ph. 610-926-1138. 10:00am to 2:00pm

**DECEMBER 14: PENNSYLVANIA RAILS TRAIN SHOW AT THE YORK FAIR GROUNDS, MEMORIAL HALL**. The Division has a table and 2 volunteers are needed to help out Don Yingling from 9am to 3pm.

**DECEMBER 27: MODULAR SHOW AT THE HERSHEY MEDICAL CENTER'S CHILDREN'S HOSPITAL WARD**. (Not open to the public or other division members, just children at the hospital).

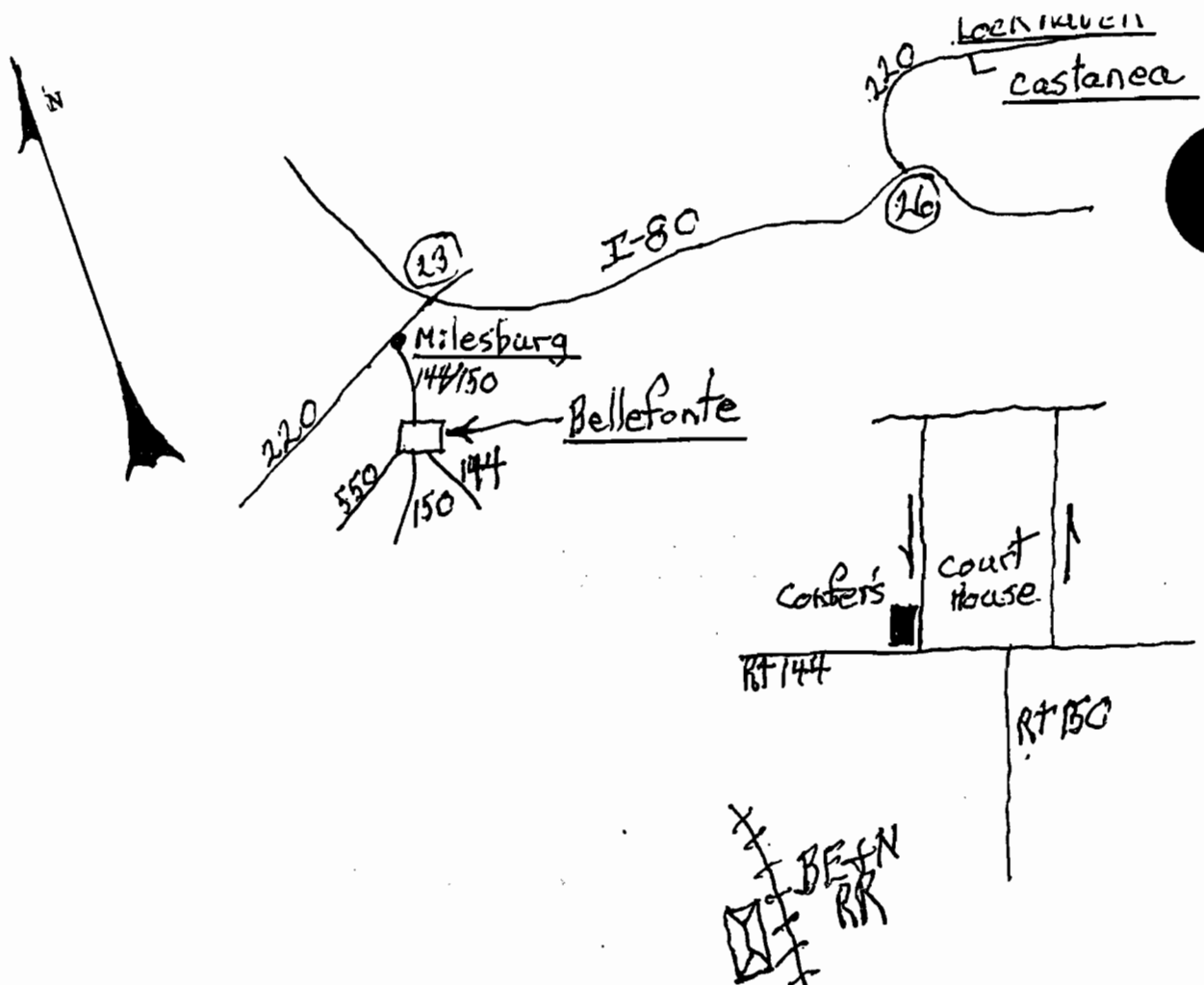

**Nittany Valley Model Railroad Club  
100 North Allegheny Street  
below Confer's Jewelers  
Bellefonte, PA 16823**

The Nittany Valley Model Railroad Club is a fully scenicked HO scale layout, below Confer's Jewelers across from the Court House in Bellefonte. This layout is designed to be operated in the entire space available. There is not much meeting space and it is not handicapped equipped.

The Susquehanna Division #11, will hold its meeting and clinics at the Clinton Central Railroad, outside of Lockhaven, in Castanea.

**Directions:** From the South take RT 150, to the intersection with RT 144 (Allegheny Street). This is the center of Bellefonte, Confer's Jewelers is next to the Court House. [Note: The gold colored parking meters are for a maximum of 15 minutes, do not use them, also, do not use the parking lot on top of the hill, it is for the prison only.] From the North, I-80 exit #23, at Mylesburg, RT 220 South to RT 144 South to Bellefonte. RT 144 is N. Allegheny Street, Confer's Jeweler's is #100.

Bellefonte is also home to the Bald Eagle and Northern Railroad, who operates out of a former PRR station 3 blocks South of the Nittany Valley Model Railroad Club. The Bald Eagle and Northern has an N scale layout in the station. They also have excursions powered by some of the last remaining RDC cars.

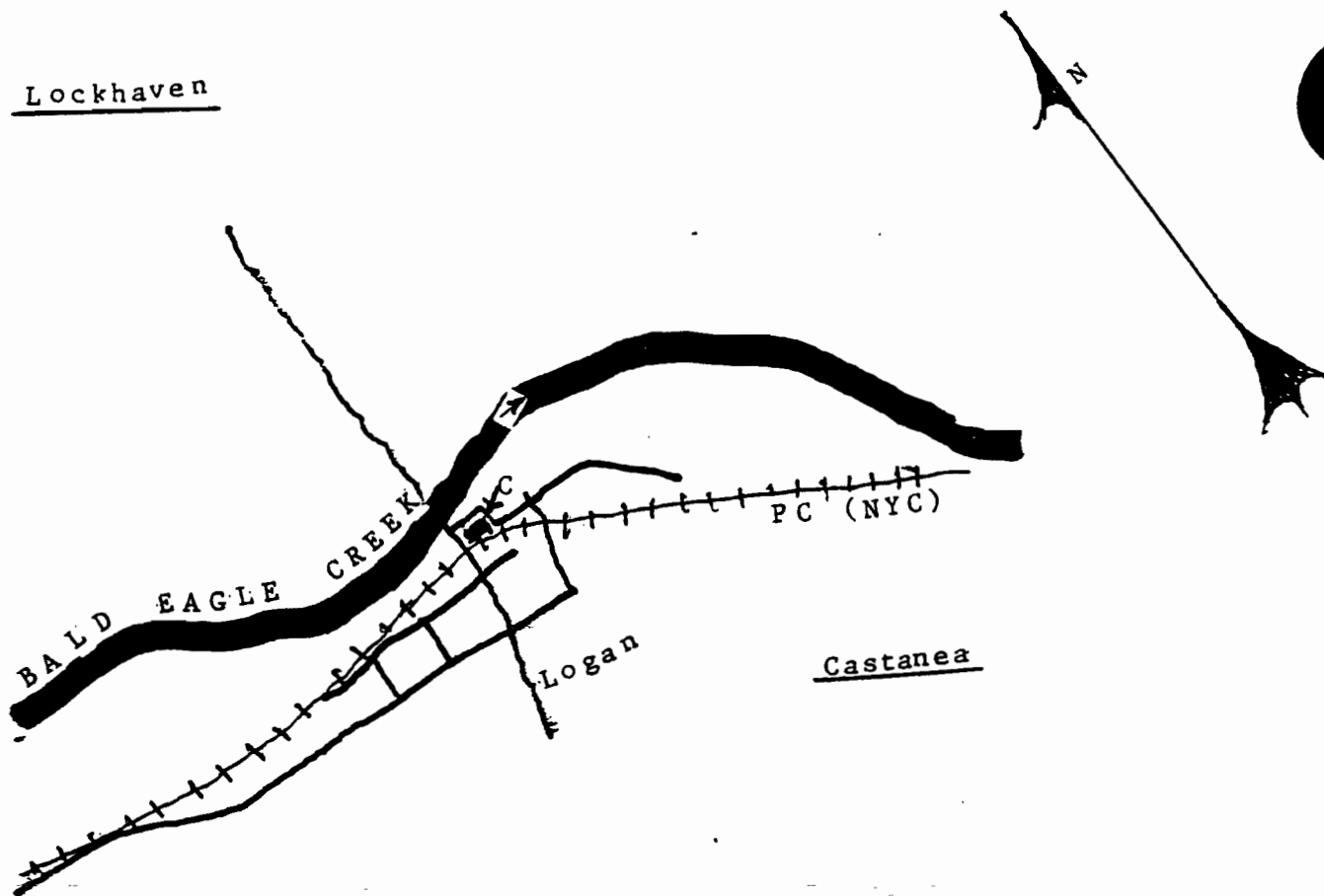

**Clinton Central Model Railroad Club**  
**15 Logan Ave**  
**Castanea, PA 17726**  
**An NMRA Member #109769**  
**Contact: John Gromley (717) 398-0698**

**The Clinton Central Model Railroad is located inside the Castanea, New York Central railroad station, just 3/4 miles South of Lockhaven, PA. They are open at 7:00 PM, on Tuesday evenings.**

**The club became a member of the NMRA in the Fall of 1996, holds an NMRA Golden Spike Award, and has an operational partially scenicked HO scale layout.**

**The interior of the station has many railroad artifacts and a reference library. The club also has HO scale private road name box cars for sale.**

**The club location is marked by a "C" with an arrow on the map.**

National Model Railroad Association  
Mid-Eastern Region  
Susquehanna Division #11  
Revenue and Expense Statement - Cash Basis  
For The Fiscal Year 7/1/96 to 6/30/97

<u>Beginning Balance (Cash) - July 1, 1996</u>		\$ 1450.27
 <u>Revenue For The Fiscal Year</u>		
Dues Received In Mail	\$ 122.00	
NMRA / MER Dues Received For Transfer	39.00	
8/9/96 - Keystone Division #2 - Sale of Hats and Mugs	48.60	
11/16/96 - York Meet -Dues	30.00	
-Raffle and Car Sales	30.75	
11/27/96 - Conewago Club Auction - Car Sales	24.00	
Miscellaneous Car and T-shirt Sales	75.00	
Donation For Module Cost- T. Nesbit	100.00	
Interest Income	22.36	
Redeposit Change - York Meet	40.00	
Total Revenue Received		<u>531.71</u>
 <u>Total Cash Available</u>		
		\$ 1981.98
 <u>Expenses For The Fiscal Year</u>		
Postage	\$ 178.49	
Printing	361.72	
Purchase Raffle Cars	84.25	
Transfer of NMRA / MER Dues	39.00	
Pay Out- Cash Change For Meets	40.00	
Coffee - York Meet	2.33	
New Checks	20.50	
Reserve Deposit - Zombo Temple Modular Meet	75.00	
Donation To York Club	25.00	
Module Construction To Date	762.08	
Total Expenses		<u>1588.37</u>
 <u>Ending Balance (Cash) - June 30, 1997</u>		
		\$ 393.61
Several Cars Remain In The Raffle Inventory		75.00
Also Box Car Kits, T-shirts, - Hats		
 <u>Susquehanna Division #11 - Organizational Net Worth</u>		 <u>\$ 468.61</u>

Respectfully Submitted,

Paul F. Tice, P.A.  
Paymaster / Clerk  
Susquehanna Division #11

# Susquehanna Division 11 Membership Application

*Mid-Eastern Region, National Model Railroad Association, Inc.*

The Susquehanna Division is located in the central portion of Pennsylvania. Counties covered are: Adams, Berks, Blair, Cambria, Carbon, Centre, Clinton, Columbia, Cumberland, Dauphin, Huntingdon, Juniata, Lackawanna, Lancaster, Lebanon, Lycoming, Lehigh, Luzerne, Lycoming, Mifflin, Monroe, Montour, Northumberland, Perry, Pike, Schuylkill, Sullivan, Susquehanna, Snyder, Union, Wayne, Wyoming, and York. Anyone interested in the hobby may become a member of the Division regardless of their place of residence. A **Regular Member** must be a member in good standing of both the MER and the NMRA and must provide the MER and NMRA membership numbers to Division 11 for verification. All others may become a **Subscriber** of the Division 11 newsletter only. Annual dues for the Susquehanna Division are **\$2.00** which includes the quarterly newsletter. Among the activities of the Division are the semi-annual mini-conventions held in the spring and fall. A quarterly newsletter, the *Susquehanna Sidetracks*, is published with the Division schedule of events and other model railroad news.

Type of application: New  Renewal  Change of Address

Primary Scale:  Layout?  Interests: Modules  Narrow Gauge  Traction  SIG

Name: \_\_\_\_\_ NMRA# \_\_\_\_\_ MER# \_\_\_\_\_

Address: \_\_\_\_\_

Phone: H (  ) \_\_\_\_\_ W (  ) \_\_\_\_\_ E-Mail Addr: \_\_\_\_\_

Return completed application, with a check payable to: *Susquehanna Division*, 1709 West Market Street, York, PA 17404

Rev 12/96-00